

BLUELEC Mini-HDMI Test Connector

MA019427

BLUELEC
Part of JOT Automation

ELECTRICAL

PINOUT socket/plug			
Pin	Name	Pin	Name
1	DATA2_SHIELD	11	CLOCK+
2	DATA2+	12	CLOCK-
3	DATA2-	13	DDC/CEC_GND
4	DATA1_SHIELD	14	CEC
5	DATA1+	15	SCL
6	DATA1-	16	SDA
7	DATA0_SHIELD	17	UTIL
8	DATA0+	18	+5V
9	DATA0-	19	DETECT
10	CLOCK_SHIELD		

CHARACTERISTICS	
Current Max.	0.4A
Voltage Max.	20Vrms
Datalines Diff. Impedance	100Ω
Operating Temperature	0°C - 60°C

MECHANICAL

Mating force	3N (typical)
Unmating force	1N (typical)
Durability	50k cycles (typical)

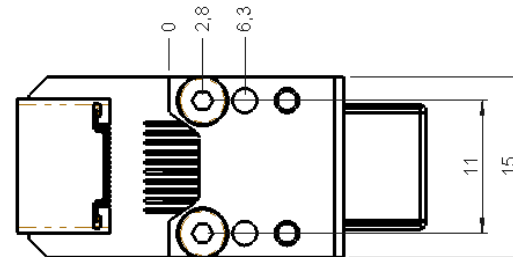
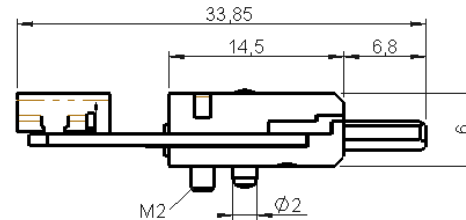

BLUELEC Mini-HDMI Test Connector MA019427 is a 19-pin test connector designed for testing of Mini-HDMI interface. The transmission of high data rates can be achieved, recommended to be verified by our customers in their applied test setup.

Accessories (sold separately): MA030010 Float unit for HDMI C Test Connector

