

GPS Coupler

MA009889

- High-quality coupler to test the GPS antenna of mobile devices
- Extremely good near-field coupling at GPS frequency (1.575 GHz)
- Outstanding small-size antenna coupler – easy to integrate for all kinds of test applications
- Suitable for high-volume production and R&D test environments

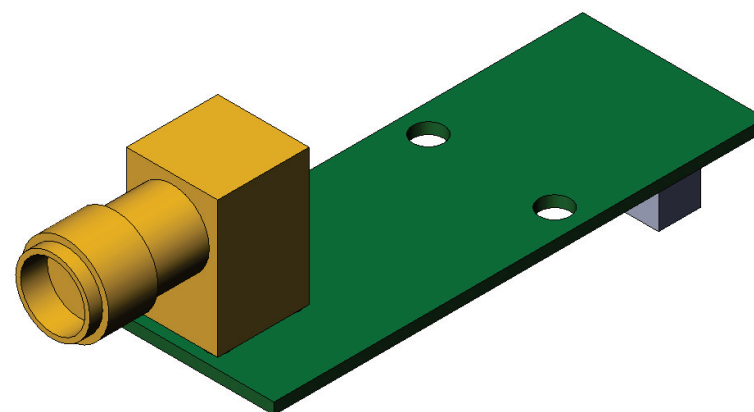

APPLICATIONS

GPS antenna for testing of mobile devices like smartphones, tablets, wearables, handheld navigators, and other portable devices with GPS.

Suitable for testing in high-volume production, R&D laboratories, service centres, and test laboratories.

TECHNICAL CHARACTERISTICS

Dimensions: 42.75 x 13 x 14.55 mm
(1.69" x 0.51" x 0.57")

INSTALLATION REQUIREMENTS

M2 plastic screws

INTERFACE

RF Connector Type: SMA (Female)

CONTACT INFO

sales@bluelec.com

TECHNICAL DETAILS

Environments	
Temperature	from 0°C to +60°C
Relative humidity	from 15% to 95% non-condensing
Specification	
Frequency	1.575 GHz
Terminal	50 ohm

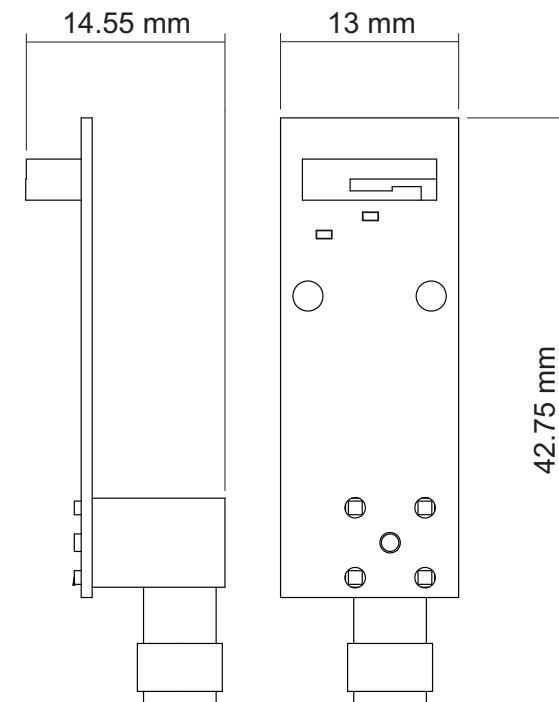

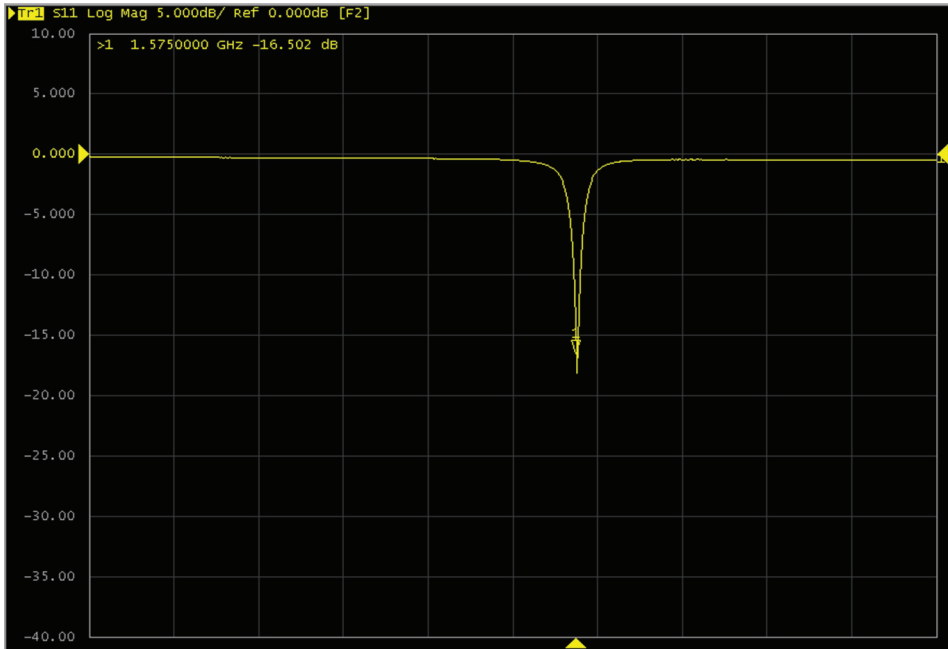

Reflection Coefficient

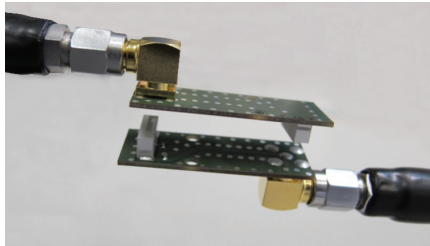

Near-field coupling of the couplers measured for a design reference. Two identical JOT MA009889 Couplers positioned contrary each other at a distance of 5 mm.

