

USB 3.0 Type-A Test Connector

MA002709

ELECTRICAL

| PINOUT | |
|-------------------|-----------|
| USB Type-A socket | |
| USB Type-A plug | |
| Pin | Name |
| 1 | VCC |
| 2 | D- |
| 3 | D+ |
| 4 | GND |
| 5 | SSRX- |
| 6 | SSRX+ |
| 7 | GND_DRAIN |
| 8 | SSTX- |
| 9 | SSTX+ |

MECHANICAL

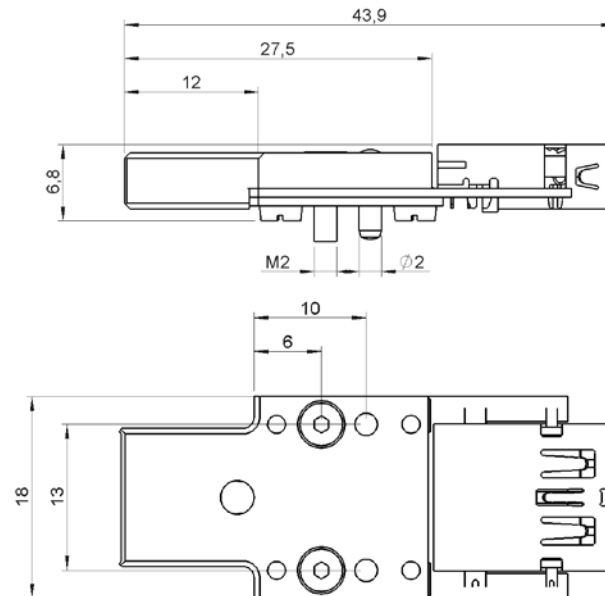

MA002709 USB 3.0 Type-A Test Connector is a 9-pin Test Plug with straight signaling. It is also compatible with USB 2.0 type-A.

MA002709 Test Plug is designed for testing of USB Type A interface.

The transmission of high data rates can be achieved, recommended to be verified by our customers in their applied test setup.

